

PTZ CAMERA SYSTEM // Ex RATED

# VT 1000 PTZ - LASER HD Ex INSPECTION CAMERA

Watertight Full HD ExRated camera with pan and tilt function, zoom and integrated lighting. Integrated 2D/3D noise reduction and visibility enhancer provide perfect pictures even in difficult conditions.



LONG TERM LEASE



## FEATURES

- Camera ATEX zone 1 rated (Ex II 2G Ex ib pxb IIC T6 Gb)  
Camera IECEx rated (Ex eb ib pxb IIC T6 Gb)
- Zoom lens 30x optical / 12x digital
- 1080i/60 Full-HD resolution
- Radiation tolerant
- Integrated LED lighting
- Pan and tilt functions
- Watertight up to 50 m

## APPLICATIONS

- All underwater inspections and monitoring applications
- Nuclear applications (refuelling – offloading – maintenance)
- Industrial applications
- Decommissioning applications

Contact us to find out more about the **VT 1000 PTZL HD Ex** or any of our other PTZ Camera Systems, or [request a quote online](#).

PTZ CAMERA SYSTEM // Ex RATED

**VT 1000 PTZ - LASER HD Ex RATED INSPECTION CAMERA**

**TECHNICAL SPECIFICATIONS**

ATEX zone	1
ATEX certification	Ex   II   2G   Ex ib pxb   IIC   T6   Gb (Camera) / Ex   II   2G [Ex ib   Gb] IIC (Box)
IECEX certification	Ex eb ib pxb   IIC   T6   Gb (Camera) / [Ex ib   Gb] IIC (Box)
Image sensor	Full HD 1080p/60 fps with 1920 x 1080 resolution (Y/Pb/Pr output)
Zoom	30x optical / 12x digital
Field of vision	63.1° wide end – 2.3° tele
Focus	Auto or manual
Pan / tilt range	Infinite / 220°
Illumination	4 x LED spot
Line laser	Parallel line laser for measurement
Length / Diameter	250 mm / 135 mm
Weight	approx 5 kg.
Ambient temperature (TA)	+1°C to +50 °C
Pressure tight	1.5 bar / 21.8 psi
IP rating / Watertightness	IP 68 - 15 meters water depth
Cable length	50 meters standard / 100 meters on request

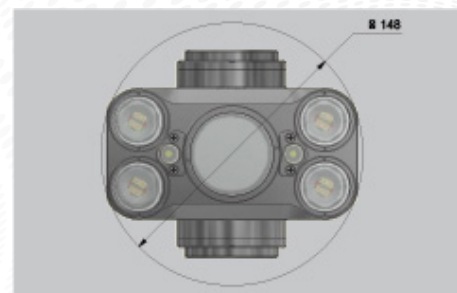
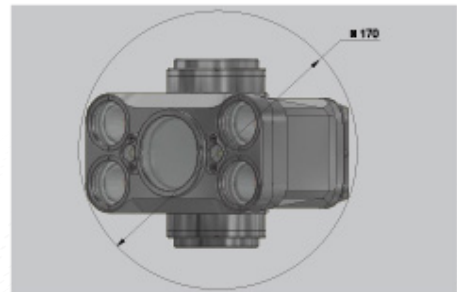
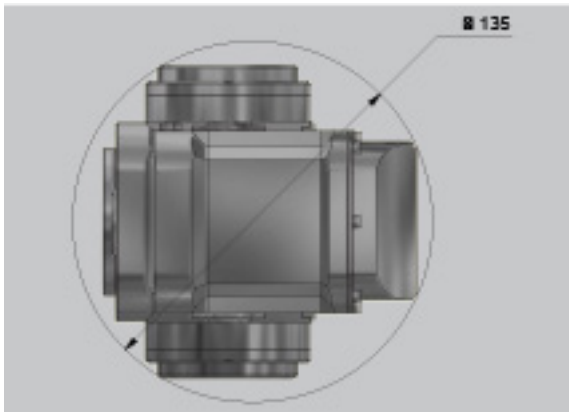

SETUP

1  
Camera



VT 1000 PTZL HD EX

2  
Cables



VT 1000 HD 5K EX



VT 1000 HD CON K

3  
Control unit



Control unit  
VT 6360 CU



Control unit  
VT 300-3 CU



Control unit  
VT CamCtrl



VT 1000 EX  
InterfaceBox



VT Nitrogen

**Components - Ex camera system components not available individually**



**VT 1000 PTZ - LASER HD Ex**  
Full HD camera with 30x optical zoom, pan and tilt function and integrated lighting



**VT 6360 CU**  
Portable CU with integrated 21.5" monitor, text inserter and recording functionality



**VT 1000 Ex Interface BOX**  
Acts as the mediator between the Ex and non Ex part of the system



**VT 1000 HD SKT Ex**  
Cable reel for VT 1000 Ex system with 50 meters of cable length



**VT Nitrogen**  
Nitrogen purge system for periodic re-pressurisation of the camera body



**VT 1000 HD CON K**  
Connects the CCU with the VT 1000 Ex Interface BOX

**Optional accessories - not ATEX / EX classified**



**Carbon poles – 29 or 42 mm diameter**  
Carbon poles for deployment of cameras and tools



**Manhole holders**  
Versatile positionner for 29 mm or 42 mm carbon poles