

MAGNAFLUX® YOKES AND YOKE KITS

MAGNAGLO®

MAGNAFLUX®

Y-6 AC Yoke

Fast, reliable AC yoke for finding surface defects.



Y-7 AC/ DC Yoke

Lightest full size AC/DC yoke for finding surface and near-surface defects.



Y-8 Battery Powered Yoke

Convenient shoulder strap battery pack offers the ultimate in portability for field inspections



MAGNETIC PARTICLE INSPECTION EQUIPMENT

- *Portable lightweight yokes for one-person inspection in tight places*
- *Adjustable legs enable you to inspect many different surface configurations*
- *One year warranty*



WWW.MAGNAFLUX.COM

MAGNAFLUX®

A Division of Illinois Tool Works Inc.

Features & Benefits

Magnaflux Yoke Kits are designed for reliable, one person magnetic particle inspection of ferrous parts when portability is essential. Because the kits are portable and the yokes fit into tight places, they are ideal for in-plant structures and field work.

Magnaflux offers a variety of options, so you can select exactly what you need – a yoke only, or a kit that also includes testing materials and accessories.

Whether you choose a Y-6 AC yoke to locate surface cracks or a Y-7 AC/DC yoke to find surface and near-surface defects or a Y-8 battery powered yoke for portability, you always get unsurpassed Magnaflux quality and reliability.

- ▶ Articulating, double-jointed legs contour easily to any part shape to assure good contact.
- ▶ Pull force (60 lbs DC, 10 lbs AC) complies with specifications.
- ▶ Solid state controls located in housing for maximum safety and reliability.
- ▶ 2-minute ON/OFF duty cycles for fast, efficient inspections (Y-6 and Y-7).
- ▶ 30 second - ON/OFF duty cycle - Y-8.

Operating Instructions

When yoke is connected to a proper power source and energized, an intense longitudinal magnetic field is created in the area between the yoke legs. Any surface cracks will create flux leakages which will attract magnetic particles that form indications that allow for detection. There are two testing methods:

- ▶ *MAGNAFLUX Dry Non-Fluorescent Method, used with a yoke, does not require a black light and is more sensitive for finding near-surface defects on components with rough surfaces, such as castings and forgings.*
- ▶ *MAGNAGLO Wet Fluorescent Method, used with a yoke and an ultraviolet black light, can find very fine surface flaws or slightly near-surface discontinuities (with Y-7 or Y-8 yokes only).*

APPLICATION INSTRUCTIONS FOR AEROSOLS & POWDERS

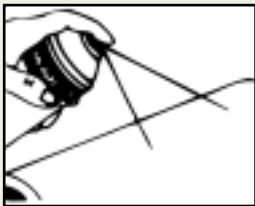

STEP 1

- ▶ *Preclean inspection area. Spray on Cleaner. Wipe off with cloth.*

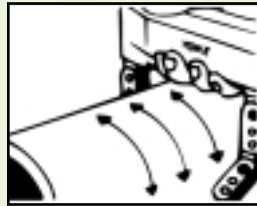

STEP 2

- ▶ *Place Yoke on test piece perpendicular to direction of suspected cracks. Energize Yoke to form a Magnetic Field.*

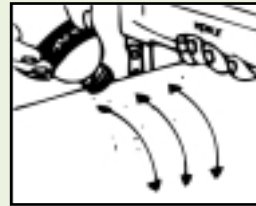

STEP 3

- ▶ *Apply magnetic powder or prepared bath while Yoke is energized.*

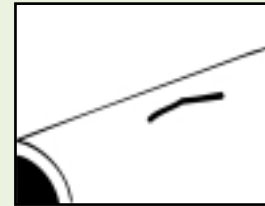

STEP 4

- ▶ *Indications will form immediately.*

Technical Specifications



Y-6 AC Yoke

- ▶ Yoke: 115v, 50/60 Hz (Part #43530)
(Specify one) 230v, 50/60 Hz (Part #43540)
- ▶ Current Draw: Less than 9 amps @115v
Less than 4 amps @230v
- ▶ Demag: Yes
- ▶ Yoke Weight: 7.3 lbs (3.1 kg)
- ▶ Leg Capacity: 0"-12" (0-30 cm) across poles
- ▶ Cord: 12 ft (365.8 cm) with grounded plug
- ▶ Other: Carrying case and instructions



Y-7 AC/DC Yoke

- ▶ Yoke: 115v, 50/60 Hz (Part #43550)
(Specify one) 230v, 50/60 Hz (Part #43560)
- ▶ Current Draw: 9 amps @ 115v AC
4 amps @ 115v DC
4 amps @ 230v
- ▶ Demag: Yes
- ▶ Yoke Weight: 7.4 lbs 115v (3.6 kg)
7.2 lbs 220v (3.27 kg)
- ▶ Leg Capacity: 0"-12" (0-30 cm) across poles
- ▶ Cord: 12 ft (365.8 cm) with grounded plug
- ▶ Other: Carrying case and instructions

Y-8 Battery Powered Yoke

Convenient shoulder strap battery pack offers the ultimate in portability for field inspections.

- ▶ Yoke: Y-8 Battery Powered Yoke ONLY* (Part #620145)
*Must choose the appropriate voltage for the battery charger.
- ▶ Battery Charger: 115v Charger (Part #620142)
230v Charger (Part #620709)
- ▶ Current Draw: 4 amps @ 6 volts DC (Yoke Only)
- ▶ Current Draw: 0.2 amps @ 115v or 230v (Charger Only)
- ▶ Demag: No
- ▶ Yoke Weight: 7 ¾ lbs.
- ▶ Leg Capacity: 0"-12" (0-30 cm) across poles
- ▶ Cord: 12 ft., coiled

BATTERY SPECIFICATIONS

- ▶ Rechargeable Battery: 6 volt, 12-amp hour
- ▶ Battery Weight: 5 ¼ lbs.
- ▶ Battery Dimensions (in.): 4 ¼" x 2 ¾" x 5 ½"
- ▶ Battery Output Voltage Charge: 6.84v/7.35v
- ▶ Battery Output Current: 1.6 amps maximum with Y-8 Yoke
- ▶ Battery Operating Temperature Range: -40°C to 60°C (-40°F to +140°F)



Y-6, Y-7 AND Y-8 YOKE KITS

Y-6 AC Yoke Kit



- Product** ▶ **Y-6 Yoke Kit**
Part# ▶ **45291:** 115v, 50/60 Hz, in case
Part# ▶ **45292:** 230v, 50/60 Hz, in case
Powders ▶ 1 lb. (.45 kg) bottles of #1 Gray, 3A Black, #8A Red
Baths ▶ 2 aerosol cans—one #9CM, one #7HF
Paint ▶ 1 aerosol can of WCP-2 White Contrast Paint
Cleaner ▶ 2 aerosol cans of SKCS
Other ▶ Also includes powder bulb, magnetic field indicator, can gun, carrying case, instructions
Kit Weight ▶ 25 lbs. (11.3 kg)

Y-7 AC/DC Yoke Kit



- Product** ▶ **Y-7 Yoke Kit**
Part# ▶ **43509:** 115v, 50/60 Hz, in case
Part# ▶ **620741:** 230v, 50/60 Hz, in case
Materials ▶ Same powders, baths, paint and cleaner as Y-6 Kit
Other ▶ Same as Y-6 Kit
Kit Weight ▶ 25 lbs. (11.3 kg)

Y-8 Battery Powered Yoke Kit



- Product** ▶ **Y-8 Yoke Kit**
Part# ▶ **611710:** 115v, 50/60 Hz, in case
Part# ▶ **611710-1:** 230v, 50/60 Hz, in case
Kit Weight ▶ 24 lbs. (10.9 kg)

Includes yoke, battery, battery pouch, battery charger, (115v, 50/60Hz or 230v, 50/60Hz), powder bulb, and one pound #1 Gray powder.

Your authorized MAGNAFLUX® Distributor



We reserve the right to change specifications without prior notice or obligation.
©2001 MAGNAFLUX

MAGNAFLUX®

A Division of Illinois Tool Works Inc.

3624 West Lake Avenue
Glenview, IL 60025
(847) 657-5300
fax (847) 657-5388
www.magnaflux.com

ITW/Chemical Brazil
Ave. Jorge Alfredo Camasmie,
350 Embu
06816-090 Sao Paulo
Brazil
55-11-4781-1577 fax 55-11-4781-1019

Faraday Road
S. Dorcan Industrial Estate
Swindon, SN3 5HE
Wiltshire, England
44-1793-524566
fax 44-1793-619498

TW/Signode Ltd.
Plot #34-35, Phase 2 IDA,
APLIC Pashammyjaram
Medak Dist. Andhra, Pradesh PIN 502305
India
91-845546055 fax 91-845546336